

1207 SOMERVILLE ROAD

DECATUR, AL

FOR SALE - RE-DEVELOPMENT LAND IN MEDICAL DISTRICT

Parker
Real Estate, LLC

\$99,000.00



DETAILS:

- RE-DEVELOPMENT PROPERTY IN THE MEDICAL DISTRICT
- ZONING: M-C MEDICAL CENTER DISTRICT
- LOT: .32 AC +/-
- STRUCTURES: ONE
- CONSTRUCTION: WOOD FRAME AND SIDING
- LOT DIMENSIONS: 100'x140'
- BUILDING SQUARE FOOTAGE: 2021 SF +/-

Parker
Real Estate, LLC

LARRY WAYE, AGENT
PARKER REAL ESTATE, LLC
401 GRANT STREET, SE - DECATUR AL 35601
256.476.6193c 256.353.1112o
lwayne@parker-realestate.com

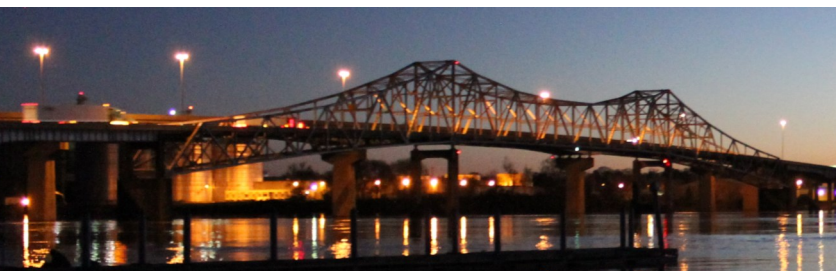

1207 SOMERVILLE ROAD

DECATUR, AL

FOR SALE - RE-DEVELOPMENT LAND IN MEDICAL DISTRICT

Parker
Real Estate, LLC

LOCATION

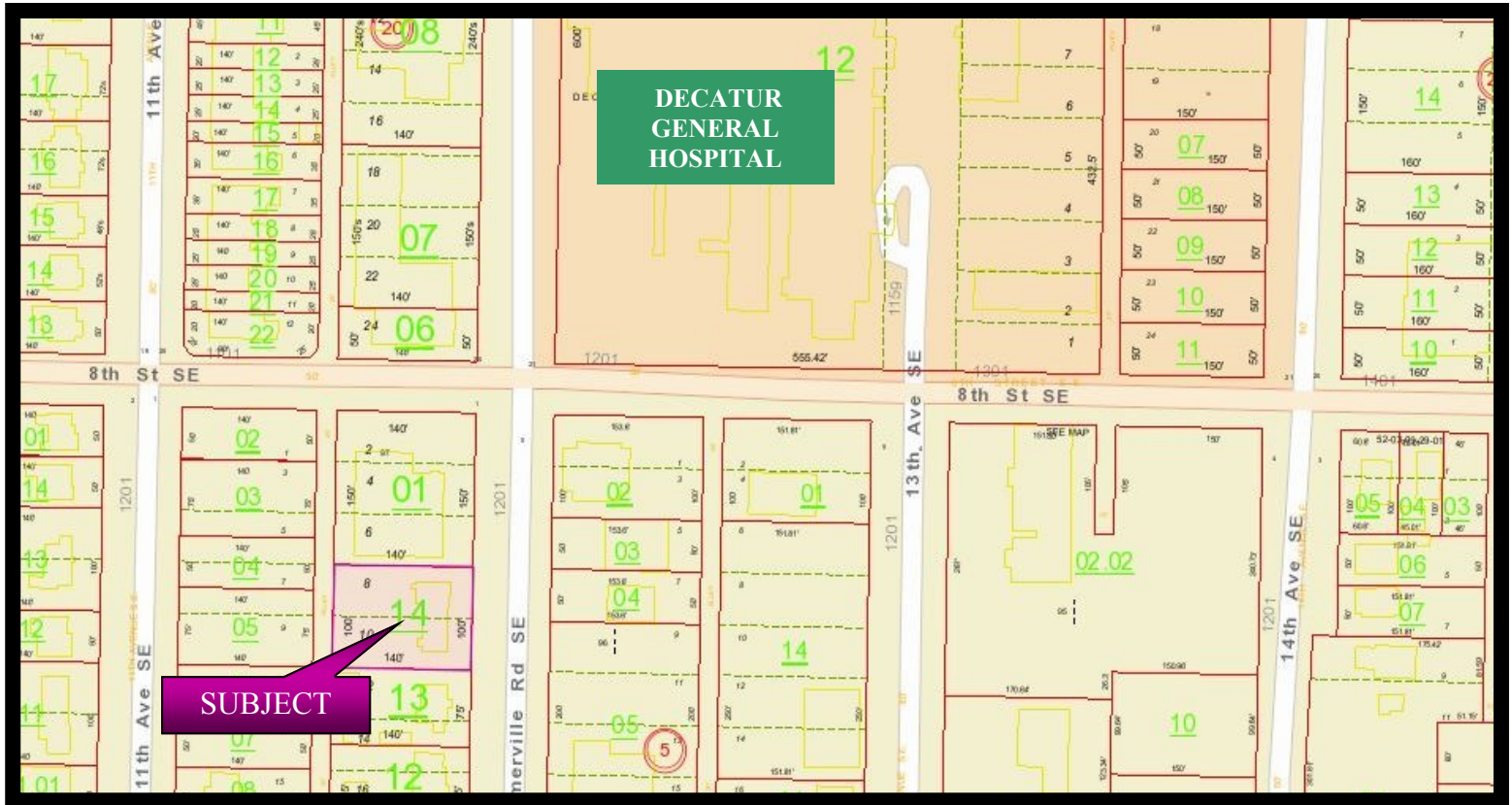

- LOCATED IN MEDICAL CENTER DISTRICT
- EXCELLENT LOCATION 1 BLOCK FROM DECATUR GENERAL HOSPITAL
- CONVENIENT TO 6TH AVENUE, POINT MALLARD PKWY & DOWNTOWN

Parker
Real Estate, LLC

LARRY WAYE, AGENT
PARKER REAL ESTATE, LLC
401 GRANT STREET, SE - DECATUR AL 35601
256.476.6193c 256.353.1112o
lwaye@parker-realestate.com

